



www.tehtools.com

Gasoline Chain Saw

TGS5818 TGS5820

To Be Your Exclusive Helper

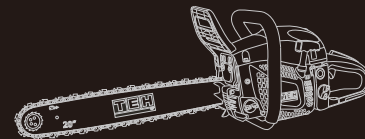

TEH



TECHNICAL SPECIFICATION

Model	TGS5818	TGS5820
Rated output power	2400w	2400w
Guide plate length	18"	20"
No-load speed	2800-3200r/min	2800-3200r/min
Engine	Type	2-stroke gasoline engine, Air cooled
	Displacement	58cc
	Fuel used	Lubricating oil mixed gasoline (mixing ratio 25:1)
Fuel tank capacity	550 ml	
Oil tank capacity	260 ml	

COMPONENTS AND ACCESSORIES

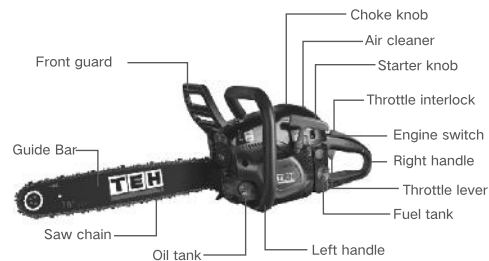

Accessories included:

- 1 instruction manual
- 1 tool kit
- 1 engine oil
- 1 oil filter
- 1 oil mixing bottle

SAFETY INSTRUCTION

BEFORE USING THE MACHINE

- a. Read this owner's manual carefully to understand how to operate this unit properly.
- b. You should never use the product when under the influence of alcohol, when suffering from exhaustion or lack of sleep, when suffering from drowsiness as a result of having taken cold medicine, or at any other time when a possibility exists that your judgment might be impaired or that you might not be able to operate the machine properly and in a safe manner.

c. Avoid running the engine indoors.

The exhaust gases contain harmful carbon monoxide.

d. Never use the product under circumstances like those described below:

1. When the ground is slippery or when other conditions exist which might make it not possible to maintain a steady posture.

2. At night, at times of heavy fog, or at any other times when your field of vision might be limited and it would be difficult to gain a clear view of the area.

3. During rain storms, during lightning storms, at times of strong or gale-force winds, or at any other times when weather conditions might make it unsafe to use this product.

e. When using this product for the first time, before beginning actual work, learn to handling it from skilled worker.

f. Lack of sleep, tiredness, or physical exhaustion results in lower attention spans, and this in may leads to accidents and injury. Limit the amount of time of using the machine continuously to somewhere around 10 minutes per session, and take 10~20 minutes of rest between work sessions. Also try to keep the total amount of work performed in a single day under 2 hours or less.

g. Be sure to keep this manual handy so that you may refer to it later whenever any questions arise.

h. Always be sure to include this manual when selling, lending, otherwise transferring the ownership of this product

i. Never allow children or anyone unable to fully understand the directions given in this manual to use this product.

WARNING GEAR AND CLOTHING

a. When using the product, you should wear proper clothing and protective equipment as follows.

(1)Helmet

(2) Protection goggles or face protector

(3) Thick work gloves

(4) Non-slip-sole work boots.

(5) Ear protectors.

b. And you should carry with you.

1. Attached tools and files.

2. Properly reserved fuel end chain oil.

3. Things to notify your working area(Rope,warning signs).

4. Whistle(for collaboration or emergency).

5. Hatchet or saw(for removal of obstacles).

c. Never use the product when wearing pants with loose cuffs, when wearing sandals, or when barefoot.

WARNING CONSIDERING HANDLING OF FUEL

a. The engine of this product is designed to run on a mixed fuel which contains highly flammable gasoline. Never store cans of fuel or refill the fuel tank in any place where there is a boiler, stove, wood fire, electrical sparks, welding sparks, or any other source of heat or fire which might ignite the fuel.

b. Smoking while operating the product or refilling its fuel tank is extremely dangerous. Always be sure to keep lit cigarettes away from the product at all times.

c. When refilling the tank always turn off the engine first and take a careful look around to make sure that there are no sparks or open flames anywhere nearby before refueling.

d. If any fuel spillage occurs during refueling, use a dry rag to wipe up spills before turning the engine back on again.

e. After refueling, screw the fuel capback tightly onto the fuel tank and then carry the product to a spot 3m or more away from where it was refueled before turning on the engine.

BEFORE STARTING ENGINE

- Check working place, the cutting object and cutting direction. if there is obstacle, remove it.
- Never start cutting until you have a clear work area, secure footing and a planned retreat path from the falling tree.
- Use caution and keep bystanders and animals out of the working area whose diameter is 2.5 times of the cutting object.
- Inspect the machine for worn, loose, or damaged parts. Never operate the machine that is damaged, improperly adjusted, or
- is not completely and securely assembled. Make sure that the saw chain stops moving when the throttle control trigger is released.

WHEN STARTING THE ENGINE

Always hold the machine firmly with both hands when the engine is running. Use a firm grip with thumb and fingers encircling the handles.

Keep all parts of your body away from the machine when the engine is running.

Before starting the engine. make sure the saw chain is not contacting anything.

INSTALLATION INSTRUCTION

INSTALLING GUIDE BAR AND SAW

Open the box and install the guide bar and the saw chain on the power unit as follows:

WARNING ⚠

The saw chain has very sharp edges. Use thick protective gloves for safety.

- Pull the guard towards the front handle to check that the chain brake is not on.
- Loosen the nuts and remove the chain cover.
- Install the attached spike to the power unit
- Gear the chain to the sprocket and, while fitting the saw chain around the guide bar, mount the guide bar to the power unit. Adjust the position of chain tensioner nut on the chain cover to the lower hole of guide bar. (F1)

- Tensioner nut
- Chain cover

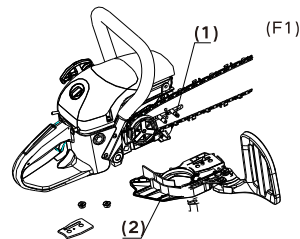

NOTE ⚠

Pay attention to the correct direction of the saw chain.(F2)

- Moving Direction

5. Fit the chain cover to the power unit and fasten the nuts to finger tightness.

6. While holding up the tip of the bar, adjust the chain tension by turning the tensioner screw until the tie straps just touch the bottom side of the bar rail (F3)

7. Tighten the nuts securely with the bar tip held up (12-15N.m). Then check the chain for smooth rotation and proper tension while moving it by hand. If necessary, readjust with the chain cover loose.

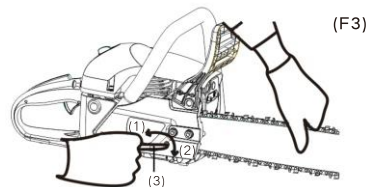
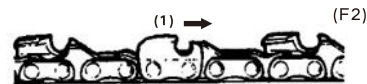

8. Tighten the tensioner screw.

- (1) Loosen
- (2) Tighten
- (3) Tensioner screw

NOTE ▲

A new chain will expand its length in the beginning of use. Check and readjust the tension frequently as a loose chain can easily derail or cause rapid wear of itself and the guide bar.

FUEL AND CHAIN OIL

Always hold the machine firmly with both hands when the engine is running. Use a firm grip with thumb and fingers encircling the handles.

Keep all parts of your body away from the machine when the engine is running.

Before starting the engine, make sure the saw chain is not contacting anything.

WARNING ▲

Gasoline is very flammable. Avoid smoking or bringing any flame or sparks near fuel.

Wipe up all spills before starting the engine.

Make sure to stop the engine and allow it cool before refueling than unit.

Keep open flames away from the area where fuel is handled or stored.

IMPORTANT

Never use oil for 4 cycle engine use or water cooled 2-cycle engine.

Never use "FUEL WITH NO OIL

(RAW GASOLINE) ". Never use fuel laced with water.

Mixed fuels which have been left unused for a period of one month or more may clog the carburetor or result in the engine failing to operate properly. Put remained fuel into an air-tight container and keep it in the dark and cool room.

Please ask for "mixed gasoline for air cooled 2-cycle engines" at your nearest gas station, or use fuel made by putting unleaded gasoline for automobiles and air-cooled 2-cycle engine oil into a mixing container in accordance with the following ratios and then shaking to mix well.

Mixing ratios:

when using TEH genuine 2-cycle

oil(FC grade):

50:1 (100 ml of oil for every 5 liters of gasoline)

When using commercially available

2-cycle oil(FB grade):

25:1 (100 ml of oil for every 4 liters of gasoline)

CHAIN OIL

Use motor oil SAE#10W-30 all year round or
SAE #30 ~ t40 in summer and SAE#20 in winter.

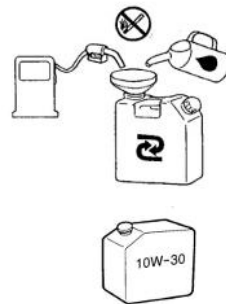

NOTE ▲

Do not use wasted or regenerated oil that can cause damage to the oil pump.

OPERATION INSTRUCTION

OPERATING ENGINE

WARNING ▲

It is very dangerous to run a chainsaw that mounts broken parts or lacks any parts. Be forstaring engine, make sure that all the parts including bar and chain are installed properly.

STARTING ENGINE

1. Fill fuel and chain oil tanks respectively, and tighten the caps securely.(F7)
2. Put the switch to "I" position.(F8)
3. Pull out the choke knob to the closed positing(F9)

- (1) Chain oil
(2) Fuel
(3) Switch
(4) Choke knob

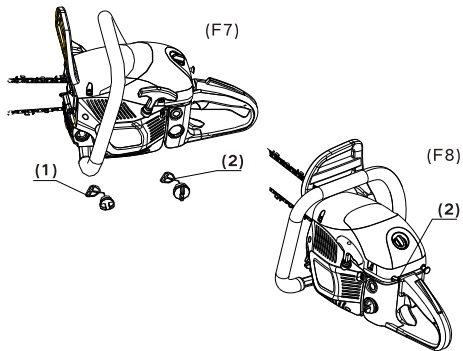

NOTE ▲

When restarting immediately after stopping the engine, leave the choke knob at the open position.

4. While holding the saw unit securely on the ground, pull the starter rope vigorously.(F10)

WARNING ▲

Do not start the engine while hanging the chain saw with a hand. The saw chain may touch your body. It's very dangerous.

5. When engine has ignited first, pull the throttle lever slightly to return the choke knob to the open position and pull the starter again to start the engine.
6. Allow the engine to warm up with the throttle lever pulled slightly.

At once pulling throttle lever out, the choke knob is automatically returned to the operating position.

WARNING ▲

Keep clear of the saw chain as it will start rotating upon starting of engine

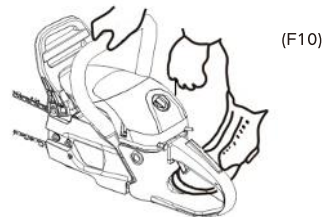
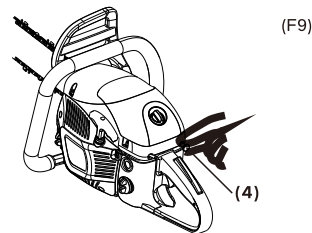

CHECKING OIL SUPPLY

WARNING ▲

Make sure to set up the bar and the chain when checking than oil supply.

If not, the rotating parts may be exposed. It is very dangerous.

After starting the engine, run the chain at medium speed and see if

chain oil is scattered off as shown in the figure(F12)

(1) chain oil

The chain oil flow can be changed by inserting a screwdriver in than hole on bottom of the clutch side. Adjust according to your work conditions.(F13)

(1) Adjuster

NOTE ▲

The oil tank should become nearly empty by the time fuel is used up. when refueling the unit, Be sure to refill the oil tank every time.

ADJUSTING CARBURETOR(F14)

The carburetor on your unit has been factory adjusted, but may require fine tuning due to change in operating conditions.

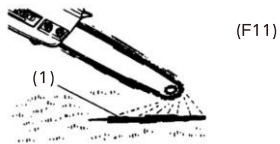

(F11)

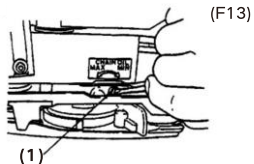

(F13)

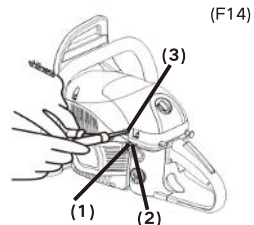

(F14)

Before adjusting the carburetor, make sure that provided are clean air/fuel filters and fresh, properly mixed fuel.

When adjusting, take the following steps;

NOTE ▲

Be sure to adjust the carburetor with the bar chain attached.

1. Stop engine and screw in both H and L needles until they stop. Never force. Then set them back the initial number of turns as shown below.

	G5200
H needle:	$\frac{3}{4} \pm \frac{3}{8}$
L needle:	$1 \frac{1}{2} \pm \frac{1}{4}$

2. Start engine and allow it to warm up at half-throttle.

3. Turn L needle slowly clockwise to find a position where idling speed is maximum, then set the needle back a quarter(1/4)turn counterclockwise.

4. Turn idle adjusting screw (T)counterclockwise so that saw chain does not turn. If idling speed is too slow, turn the screw clockwise.

5. Make a test cut and adjust the H needle for best cutting power. not for maximum speed.

(1) L needle

(2) H needle

(3) Idle adjusting screw

CARBURETOR ANTI-FREEZE MECHANISM

Operating the chain saw in temperatures of 0-5 ° C at times of high humidity may result in ice forming within the carburetor, and this in turn may cause the output power of the engine to be reduced or for the engine to fail to operate smoothly.

This product has accordingly been designed with a ventilation hatch the back of the air cleaner cover to allow warm air to be supplied to the engine and to thereby prevent icing from occurring.

Under normal circumstances the product should be used in normal operating mode, i.e., in the mode to which it is set at the time of shipment. However when the possibility exists that icing may occur, the unit should be set to operate in anti-freeze mode before use.

WARNING ⚠

Continuing to use the product in anti-freeze mode even when temperatures have risen and returned to normal may result in the engine failing to start properly or in the engine failing to operate at its normal speed, and for this reason you should always be sure to return the unit to normal operating mode if there is no danger of icing occurring-

HOW TO SWITCH BETWEEN OPERATING MODES(F16)

- 1.Please put(1)into (2) in the summer
 - 2.Please take(1)out(2)in the Winter
- (1)rubber
(2)plasti

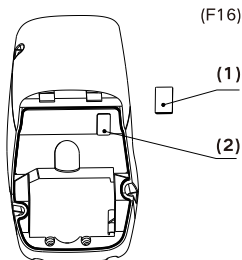

WARNING ⚠

Continuing to use the product in anti-freeze mode even when temperatures have risen and returned to normal may result in the engine failing to start properly or in the engine failing to operate at its normal speed, and for this reason you should always be sure to return the unit to normal operating mode if there is no danger of icing occurring.

NOTE ⚠

When using the unit at times when it is snowing, TEH recommends that you also use a snow protector effective in preventing the air filter from freezing((F17)

- (1)Snow protector

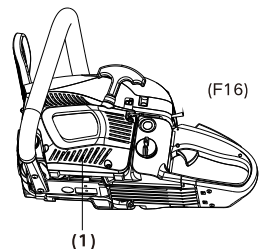

CHAIN BRAKE(F18)

This brake can be operated manually with the front guard turned down to the guide bar.

To release brake, pull up the front guard toward the front handle till "click" sound is heard.

- (1) Break (Front Guard)
(2) Released
(3) Operated

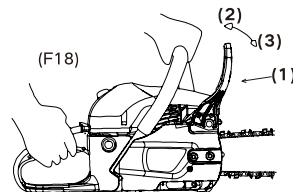

WARNING ▲

Be sure to confirm brake operation on the daily inspection.

In case the brake is not effective, ask our dealer inspection and repairing.

The engine, if being kept rotated at high speed with the brake engaged, heats the clutch, causing a trouble.

When the brake is operated while in operation, immediately release your fingers from the throttle lever and keep the engine idling.

STOPPING ENGINE

1. Release the throttle lever to allow the engine idling for a few minutes.
 2. Put the switch to the "O"(STOP)position.(F20)
- (1)Switch

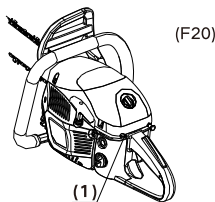
**SAWING****WARNING** ▲

1. Before proceeding to your job, read "For Safe Operation" section it is recommended to first practice sawing easy logs This also helps you get accustomed to your unit.

2. Always follow the safety regulations. The chain saw must only be used for cutting wood. It is forbidden to cut other types of material. Vibrations and kickback vary with different materials and the requirements of the safety regulations would not be respected. Do not use the chain saw as a lever for lifting, moving or splitting objects. Do not lock it over fixed stands. It is forbidden to use tools or applications to the P.t.o. that are not specified by the manufacturer.

3. It is not necessary to force the saw into the cut. Apply only light pressure while running the engine at full throttle.

4. When the saw chain is caught in the cut, do not attempt to pull it out by force, but use a wedge or a lever to open the way.

GUARD AGAINST KICKBACK (F21)

It is extremely important that the chain brake be checked for proper operation before each use and that the chain be sharp in order to maintain the kickback safety level of this saw. Removal of the safety devices, inadequate maintenance, or incorrect replacement of the bar or chain may increase the risk to serious personal injury due to kickback.

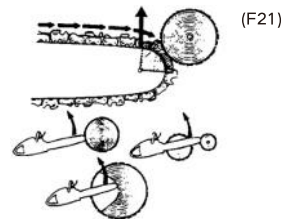
**GUARD AGAINST KICKBACK (F22)**

1. Decide the felling direction considering the wind, lean of the tree, location of heavy branches, ease of job after felling and other factors.
2. While clearing the area around the tree, arrange a good foothold and retreat path.
3. Make a notch cut one-third of the way into the tree on the felling side.
4. Make a felling cut from the opposite side of the notch and of a level slightly higher than the bottom of the notch.

WARNING ⚠

when you fell a tree, be sure to warn your neighboring workers of the danger.

- (1) Notch cut
- (2) Felling cut
- (3) Felling direction bucking and Limbing

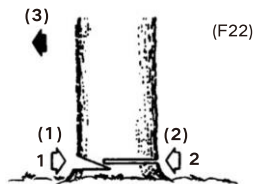
**WARNING** ⚠

Always ensure your foothold. Do not stand on the log.

Be alert to the rolling over of a cut log. Especially when working on a slope, stand on the uphill side of the log.

Follow the instructions in "For Safe Operation" to avoid kickback of the saw.

Before starting work, check the direction of bending force inside the log to be cut. Always finish cutting from the opposite side of bending direction to prevent the guide bar from being caught in the cut.

A Log lying on the ground(F23)

saw down halfway, then roll the log over and cut from the opposite side.

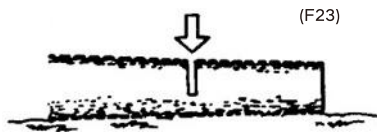

A Log hanging off the ground(F24)

In area A, saw up from the bottom one-third and finish by sawing down from the top. In area B, saw down from the top one-third and finish by sawing up from the bottom.

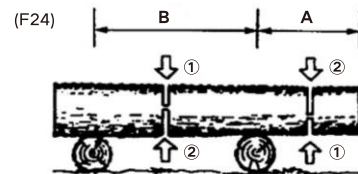

Cutting Limb of Fallen Tree(F25)

First check to which side the limb is bent. Then make the initial cut from the bent side and finish by sawing from the opposite side.

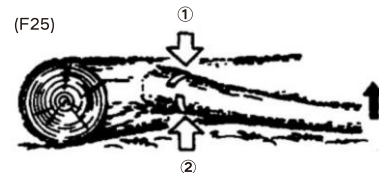
**WARNING** ⚠

Be alert to the springing back of a cut limb.

Pruning of Standing Tree(F26)

Cut up from the bottom, finish down from the top.

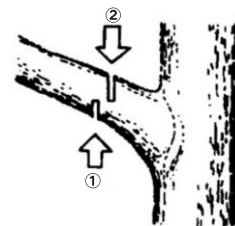

WARNING ⚠

Do not use an unstable foothold or ladder.
 Do not overreach
 Do not cut above shoulder height.
 Always use your both hands to grip the saw.

MAINTENANCE**WARNING** ⚠

Before cleaning, inspecting or repairing your unit, make sure that engine has stopped and is cool. Disconnect the spark plug to prevent accidental starting.

AIR FILTER

Dust on the cleaner surface can be removed by tapping a corner of the cleaner against a hard surface. To clean dirt in the meshes, split the cleaner into halves and brush in gasolins. When using compressed air, blow from the inside.(F27)
 To assemble the cleaner halves,press the rim until it clicks

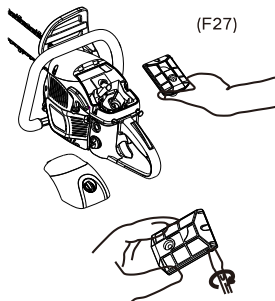

19

NOTE ⚠

when installing the main filter, make sure that the grooves on the filter edge are correctly fit with the projections on the cylinder cover.

OILING PORT

Dismount the guide bar and check the oiling port for clogging.(F28)
 (1)Oiling port

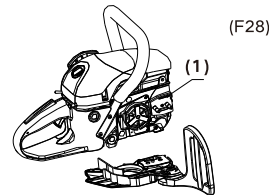
**GUIDE BAR**

when the guide bar is dismounted.
 remove sawdust in the bar groove and the oiling port.(F29)
 Grease the nose sprocket from the feeding port on the tip of the bar.(F30)
 (1)Oiling port
 (2)Grease port
 (3)Sprocket

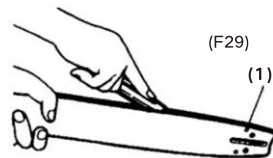

20

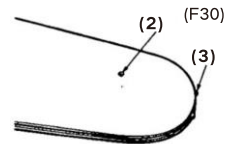

OTHERS

Check for fuel leakage and loose fastenings and damage to major parts, especially handle joints and guide bar mounting. If any defects are found, make sure to have them repaired before operating again.

WARRANTY CARD

Dear customers, the warranty service for purchasing TEH products is as follows:

Under normal use, within three months from the date of purchase. It is guaranteed that the damage is caused by the quality of the tool.

The following conditions occur during the warranty period, not covered by the warranty:

- a. Any valid legal document (single ticket) certifying the date of purchase
- b. Any damage caused by natural wear and overload
- c. Any damage caused by the use of low-priced inferior accessories
- d. Any damage caused by improper carrying, transportation or storage
- e. Any product that has been opened, repaired, replaced, or modified by itself
- f. Any damage caused by misuse, beyond the scope of use of the tool, and failure to use and maintain in accordance with the instructions

 ladies/gentlemen: _____ employer: _____

contact number: _____ fax number: _____

contact address: _____

warranty record: _____

post code: _____

IMPORTANT NOTE

1. The invoice and warranty card must be presented at the time of warranty.
2. The fuselage number on the invoice is the same as the fuselage number on the warranty card.
3. Once this warranty card is issued, if it is lost, it will not be reissued. Please keep it properly.

Note: The company reserves the right to amend the above provisions and has the final interpretation right in the case that the warranty service does not violate national laws.